

### Kolano 90°

GOE | GW x GW

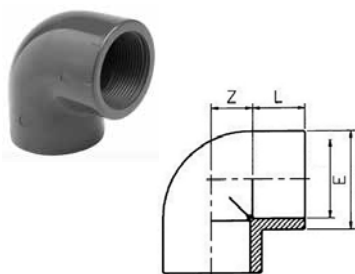

| G      | SYMBOL  | L    | Z    | E    | PN |
|--------|---------|------|------|------|----|
| 3/8"   | 1110467 | 11.4 | 11.6 | 23.5 | 16 |
| 1/2"   | 1110468 | 15.0 | 12   | 27.5 | 16 |
| 3/4"   | 1110469 | 16.3 | 16.7 | 33.5 | 16 |
| 1"     | 1110470 | 19.1 | 19.9 | 42   | 16 |
| 1 1/4" | 1110471 | 21.4 | 25.6 | 51   | 16 |
| 1 1/2" | 1110472 | 21.4 | 35.6 | 62   | 16 |
| 2"     | 1110473 | 25.7 | 45.3 | 77   | 16 |
| 2 1/2" | 1110474 | 30.2 | 52.8 | 89   | 16 |
| 3"     | 1110475 | 33.3 | 64.7 | 106  | 16 |
| 4"     | 1110476 | 39.3 | 78.7 | 129  | 16 |

### Kolano 45°

GYE | GW x GW

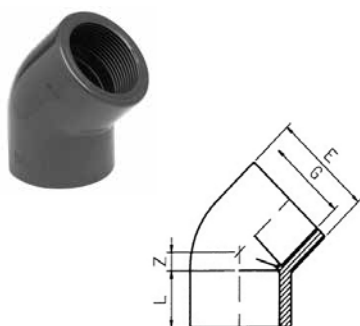

| G      | SYMBOL  | L  | Z  | E   | PN |
|--------|---------|----|----|-----|----|
| 1/2"   | 1110477 | 15 | 6  | 28  | 16 |
| 3/4"   | 1110478 | 16 | 9  | 34  | 16 |
| 1"     | 1110479 | 19 | 11 | 42  | 16 |
| 1 1/4" | 1110480 | 21 | 15 | 51  | 16 |
| 1 1/2" | 1110481 | 21 | 22 | 62  | 16 |
| 2"     | 1110482 | 26 | 26 | 77  | 16 |
| 2 1/2" | 1110483 | 30 | 31 | 89  | 16 |
| 3"     | 1110786 | 33 | 38 | 106 | 16 |
| 4"     | 1110787 | 39 | 46 | 129 | 16 |

### Kolano 90°

GRE | GW x GZ

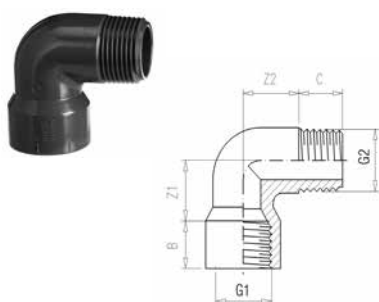

| G1 x G2     | SYMBOL  | Z1   | Z2   | B  | C  | PN |
|-------------|---------|------|------|----|----|----|
| 1/2" x 1/2" | 1120485 | 20.5 | 20.5 | 16 | 16 | 16 |
| 3/4" x 3/4" | 1120486 | 24.5 | 24.5 | 17 | 17 | 16 |
| 1" x 1"     | 1120487 | 30   | 30   | 21 | 21 | 16 |

#### Powiązane produkty:

Nitka teflonowa



Str. 150

Taśma teflonowa



Str. 150

### Trójnik

TIE | GW x GW x GW

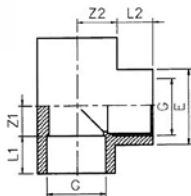

| G      | SYMBOL  | L1/L2 | Z1/Z2 | E    | PN |
|--------|---------|-------|-------|------|----|
| 3/8"   | 1110590 | 11,4  | 11,6  | 23,5 | 16 |
| 1/2"   | 1110591 | 15    | 12    | 27,5 | 16 |
| 3/4"   | 1110592 | 16,3  | 16,7  | 33,5 | 16 |
| 1"     | 1110593 | 19,1  | 19,9  | 42   | 16 |
| 1 1/4" | 1110594 | 21,4  | 25,6  | 51   | 16 |
| 1 1/2" | 1110595 | 21,4  | 35,6  | 62   | 16 |
| 2"     | 1110596 | 25,7  | 45,3  | 77   | 16 |
| 2 1/2" | 1110597 | 30,2  | 52,8  | 89   | 16 |
| 3"     | 1110598 | 33,3  | 64,7  | 106  | 16 |
| 4"     | 1110599 | 33,3  | 78,7  | 129  | 16 |

### Złączka

MAE | GW x GW

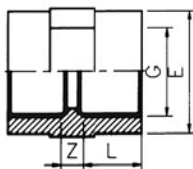

| G      | SYMBOL  | L  | Z  | E   | PN |
|--------|---------|----|----|-----|----|
| 3/8"   | 1110484 | 11 | 6  | 23  | 16 |
| 1/2"   | 1110485 | 15 | 7  | 27  | 16 |
| 3/4"   | 1110486 | 16 | 7  | 33  | 16 |
| 1"     | 1110487 | 19 | 8  | 41  | 16 |
| 1 1/4" | 1110488 | 21 | 8  | 50  | 16 |
| 1 1/2" | 1110489 | 21 | 8  | 61  | 16 |
| 2"     | 1110490 | 26 | 8  | 75  | 16 |
| 2 1/2" | 1110491 | 30 | 9  | 88  | 16 |
| 3"     | 1110492 | 33 | 10 | 106 | 16 |
| 4"     | 1110493 | 39 | 11 | 129 | 16 |

### Redukcja

MRE | GW x GW

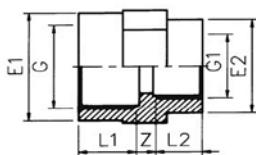

| G x G1          | SYMBOL  | L1 | L2 | Z  | E1  | E2  | PN |
|-----------------|---------|----|----|----|-----|-----|----|
| 1/2" x 3/8"     | 1110503 | 15 | 11 | 6  | 28  | 23  | 16 |
| 3/4" x 1/2"     | 1110504 | 16 | 15 | 7  | 34  | 27  | 16 |
| 1" x 3/4"       | 1110505 | 19 | 16 | 7  | 42  | 33  | 16 |
| 1 1/4" x 1"     | 1110506 | 21 | 19 | 8  | 51  | 41  | 16 |
| 1 1/2" x 1 1/4" | 1110507 | 21 | 21 | 8  | 58  | 50  | 16 |
| 2" x 1 1/2"     | 1110508 | 26 | 21 | 8  | 72  | 61  | 16 |
| 2 1/2" x 2"     | 1110509 | 30 | 26 | 8  | 89  | 75  | 16 |
| 3" x 2 1/2"     | 1110510 | 33 | 30 | 9  | 103 | 88  | 16 |
| 4" x 3"         | 1110511 | 39 | 33 | 10 | 130 | 106 | 16 |

### Redukcja krótka

RCE | GZ x GW

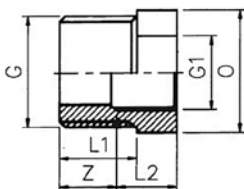

| G x G1          | SYMBOL  | L1 | L2 | Z  | O   | PN |
|-----------------|---------|----|----|----|-----|----|
| 1/2" x 1/4"     | 1110549 | 15 | 11 | 16 | 24  | 16 |
| 3/4" x 1/2"     | 1110550 | 16 | 15 | 13 | 30  | 16 |
| 1" x 3/4"       | 1110551 | 19 | 16 | 15 | 36  | 16 |
| 1 1/4" x 1"     | 1110552 | 21 | 19 | 16 | 46  | 16 |
| 1 1/2" x 1 1/4" | 1110553 | 21 | 21 | 14 | 50  | 16 |
| 2" x 1 1/2"     | 1110554 | 26 | 21 | 18 | 65  | 16 |
| 2 1/2" x 2"     | 1110555 | 30 | 26 | 21 | 80  | 16 |
| 3" x 2 1/2"     | 1110556 | 33 | 30 | 20 | 95  | 16 |
| 4" x 3"         | 1110557 | 39 | 33 | 24 | 120 | 16 |

### Redukcja

MGE | GZ x GW

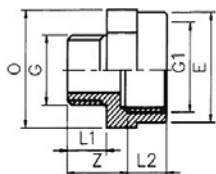

| G x G1          | SYMBOL  | L1 | L2 | Z  | O   | E   | PN |
|-----------------|---------|----|----|----|-----|-----|----|
| 3/8" x 1/2"     | 1110494 | 11 | 15 | 22 | 30  | 28  | 16 |
| 1/2" x 3/4"     | 1110495 | 15 | 16 | 24 | 36  | 34  | 16 |
| 3/4" x 1"       | 1110496 | 16 | 19 | 26 | 46  | 42  | 16 |
| 1" x 1 1/4"     | 1110497 | 19 | 21 | 30 | 55  | 51  | 16 |
| 1 1/4" x 1 1/2" | 1110498 | 21 | 21 | 33 | 60  | 58  | 16 |
| 1 1/2" x 2"     | 1110499 | 21 | 26 | 34 | 75  | 72  | 16 |
| 2" x 2 1/2"     | 1110500 | 26 | 30 | 38 | 90  | 89  | 16 |
| 2 1/2" x 3"     | 1110501 | 30 | 33 | 44 | 105 | 103 | 16 |
| 3" x 4"         | 1110502 | 33 | 39 | 48 | 130 | 130 | 16 |

### Redukcja

RIE | GZ x GW

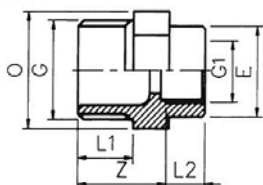

| G x G1          | SYMBOL  | L1 | L2 | Z  | E   | O   | PN |
|-----------------|---------|----|----|----|-----|-----|----|
| 1/2" x 3/8"     | 1110558 | 15 | 11 | 24 | 23  | 24  | 16 |
| 3/4" x 3/8"     | 1110559 | 16 | 11 | 25 | 23  | 30  | 16 |
| 3/4" x 1/2"     | 1110560 | 16 | 15 | 26 | 28  | 30  | 16 |
| 1" x 3/8"       | 1110561 | 19 | 11 | 28 | 23  | 36  | 16 |
| 1" x 1/2"       | 1110562 | 19 | 15 | 29 | 28  | 36  | 16 |
| 1" x 3/4"       | 1110563 | 19 | 16 | 30 | 34  | 36  | 16 |
| 1 1/4" x 1/2"   | 1110564 | 21 | 15 | 33 | 28  | 46  | 16 |
| 1 1/4" x 3/4"   | 1110565 | 21 | 16 | 33 | 34  | 46  | 16 |
| 1 1/4" x 1"     | 1110566 | 21 | 19 | 33 | 42  | 46  | 16 |
| 1 1/2" x 3/4"   | 1110567 | 21 | 16 | 34 | 34  | 50  | 16 |
| 1 1/2" x 1"     | 1110568 | 21 | 19 | 34 | 42  | 50  | 16 |
| 1 1/2" x 1 1/4" | 1110569 | 21 | 21 | 34 | 51  | 55  | 16 |
| 2" x 1"         | 1110570 | 26 | 19 | 37 | 42  | 65  | 16 |
| 2" x 1 1/4"     | 1110571 | 26 | 21 | 37 | 51  | 65  | 16 |
| 2" x 1 1/2"     | 1110572 | 26 | 21 | 37 | 58  | 65  | 16 |
| 2 1/2" x 1 1/4" | 1110573 | 30 | 21 | 43 | 51  | 80  | 16 |
| 2 1/2" x 1 1/2" | 1110574 | 30 | 21 | 43 | 58  | 80  | 16 |
| 2 1/2" x 2"     | 1110575 | 30 | 26 | 43 | 72  | 80  | 16 |
| 3" x 1 1/2"     | 1110577 | 33 | 21 | 47 | 58  | 95  | 16 |
| 3" x 2"         | 1110578 | 33 | 26 | 47 | 72  | 95  | 16 |
| 3" x 2 1/2"     | 1110576 | 33 | 30 | 47 | 89  | 95  | 16 |
| 4" x 2"         | 1110579 | 39 | 26 | 53 | 72  | 120 | 16 |
| 4" x 2 1/2"     | 1110580 | 39 | 30 | 53 | 89  | 120 | 16 |
| 4" x 3"         | 1110581 | 39 | 33 | 53 | 103 | 120 | 16 |

### Nypel

NIE | GZ x GZ

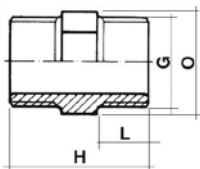

| G      | SYMBOL  | L    | H  | O   | PN |
|--------|---------|------|----|-----|----|
| 3/8"   | 1110512 | 11.4 | 33 | 22  | 16 |
| 1/2"   | 1110513 | 15   | 42 | 24  | 16 |
| 3/4"   | 1110514 | 16.3 | 44 | 30  | 16 |
| 1"     | 1110515 | 19.1 | 50 | 36  | 16 |
| 1 1/4" | 1110516 | 21.4 | 58 | 46  | 16 |
| 1 1/2" | 1110517 | 21.4 | 58 | 50  | 16 |
| 2"     | 1110518 | 25.7 | 66 | 65  | 16 |
| 2 1/2" | 1110519 | 30.2 | 78 | 80  | 16 |
| 3"     | 1110520 | 33.3 | 85 | 95  | 16 |
| 4"     | 1110521 | 39.3 | 96 | 120 | 16 |

### Nypel redukcyjny

NRE | GZ x GZ

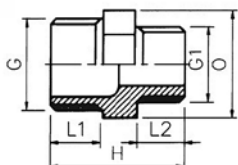

| G x G1          | SYMBOL  | L1 | L2 | H  | O   | PN |
|-----------------|---------|----|----|----|-----|----|
| 1/2" x 3/8"     | 1110522 | 15 | 11 | 38 | 24  | 16 |
| 3/4" x 1/2"     | 1110523 | 16 | 15 | 43 | 30  | 16 |
| 1" x 3/4"       | 1110524 | 19 | 16 | 47 | 36  | 16 |
| 1 1/4" x 1"     | 1110525 | 21 | 19 | 56 | 46  | 16 |
| 1 1/2" x 1 1/4" | 1110526 | 21 | 21 | 58 | 50  | 16 |
| 2" x 1 1/2"     | 1110528 | 26 | 21 | 62 | 65  | 16 |
| 2 1/2" x 2"     | 1110529 | 30 | 26 | 73 | 80  | 16 |
| 3" x 2"         | 1110530 | -  | -  | -  | -   | 16 |
| 3" x 2 1/2"     | 1110531 | 33 | 30 | 82 | 95  | 16 |
| 4" x 3"         | 1110532 | 39 | 33 | 90 | 120 | 16 |

### Korek

CAE | GW

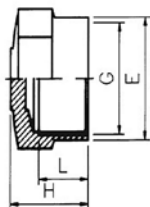

| G      | SYMBOL  | L  | H  | E   | PN |
|--------|---------|----|----|-----|----|
| 3/8"   | 1110456 | 11 | 22 | 23  | 10 |
| 1/2"   | 1110457 | 15 | 21 | 28  | 10 |
| 3/4"   | 1110458 | 16 | 23 | 34  | 10 |
| 1"     | 1110459 | 19 | 26 | 42  | 10 |
| 1 1/4" | 1110460 | 21 | 29 | 51  | 10 |
| 1 1/2" | 1110461 | 21 | 32 | 61  | 10 |
| 2"     | 1110462 | 26 | 37 | 75  | 10 |
| 2 1/2" | 1110463 | 30 | 50 | 89  | 10 |
| 3"     | 1110464 | 33 | 53 | 103 | 10 |
| 4"     | 1110465 | 39 | 59 | 130 | 10 |

### Korek płaski

CAH | GW

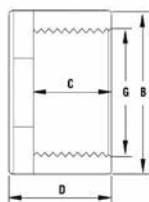

| G      | SYMBOL  | B   | C  | D  | PN |
|--------|---------|-----|----|----|----|
| 1/2"   | 1110024 | 29  | 16 | 24 | 10 |
| 3/4"   | 1110025 | 34  | 19 | 28 | 10 |
| 1"     | 1110026 | 44  | 22 | 33 | 10 |
| 1 1/4" | 1110027 | 47  | 26 | 37 | 10 |
| 1 1/2" | 1110028 | 55  | 31 | 43 | 10 |
| 2"     | 1110029 | 69  | 38 | 51 | 10 |
| 2 1/2" | 1110030 | 87  | 44 | 64 | 10 |
| 3"     | 1110031 | 103 | 51 | 76 | 10 |
| 4"     | 1110032 | 130 | 61 | 91 | 10 |

### Korek płaski z uszczelką

COE | GW

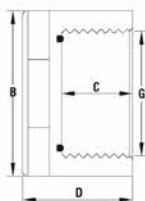

| G      | SYMBOL  | B   | C  | D  | PN |
|--------|---------|-----|----|----|----|
| 1/2"   | 1110852 | 29  | 13 | 24 | 10 |
| 3/4"   | 1110853 | 34  | 15 | 28 | 10 |
| 1"     | 1110854 | 44  | 18 | 33 | 10 |
| 1 1/4" | 1110855 | 47  | 20 | 37 | 10 |
| 1 1/2" | 1110856 | 55  | 20 | 43 | 10 |
| 2"     | 1110857 | 69  | 25 | 51 | 10 |
| 2 1/2" | 1110858 | 87  | 29 | 64 | 10 |
| 3"     | 1110859 | 103 | 32 | 76 | 10 |
| 4"     | 1110860 | 130 | 36 | 91 | 10 |

**Korek**  
TAE | GZ

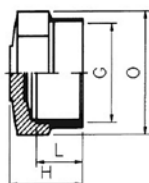

| G      | SYMBOL         | L  | H  | O   | PN |
|--------|----------------|----|----|-----|----|
| 3/8"   | <b>1110582</b> | 11 | 23 | 19  | 16 |
| 1/2"   | <b>1110583</b> | 15 | 29 | 24  | 16 |
| 3/4"   | <b>1110584</b> | 16 | 30 | 30  | 16 |
| 1"     | <b>1110585</b> | 19 | 33 | 36  | 16 |
| 1 1/4" | <b>1110586</b> | 21 | 39 | 46  | 16 |
| 1 1/2" | <b>1110587</b> | 21 | 39 | 50  | 16 |
| 2"     | <b>1110588</b> | 26 | 43 | 65  | 16 |
| 2 1/2" | <b>1121370</b> | 30 | 51 | 80  | 16 |
| 3"     | <b>1110589</b> | 33 | 56 | 95  | 16 |
| 4"     | <b>1111048</b> | 39 | 63 | 120 | 16 |

**Korek płaski**  
TAH | GZ

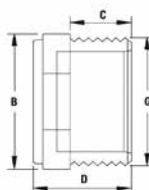

| G      | SYMBOL         | B   | C  | D  | PN |
|--------|----------------|-----|----|----|----|
| 1/2"   | <b>1110015</b> | 29  | 14 | 31 | 10 |
| 3/4"   | <b>1110016</b> | 34  | 16 | 32 | 10 |
| 1"     | <b>1110017</b> | 44  | 19 | 35 | 10 |
| 1 1/4" | <b>1110018</b> | 47  | 21 | 38 | 10 |
| 1 1/2" | <b>1110019</b> | 55  | 21 | 40 | 10 |
| 2"     | <b>1110020</b> | 69  | 26 | 46 | 10 |
| 2 1/2" | <b>1110021</b> | 87  | 30 | 51 | 10 |
| 3"     | <b>1110022</b> | 103 | 33 | 58 | 10 |
| 4"     | <b>1110023</b> | 130 | 38 | 65 | 10 |

Powiązane produkty:

Nitka teflonowa



Str. 150

Taśma teflonowa



Str. 150

**Kolano 90°**  
GOG | KW x GW

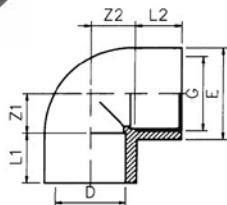

| D x G       | SYMBOL  | L1 | L2 | Z1 | Z2 | E   | PN |
|-------------|---------|----|----|----|----|-----|----|
| 16 x 3/8"   | 1110708 | 14 | 11 | 9  | 12 | 23  | 10 |
| 20 x 1/2"   | 1110709 | 16 | 15 | 11 | 12 | 28  | 10 |
| 25 x 3/4"   | 1110710 | 19 | 16 | 14 | 17 | 34  | 10 |
| 32 x 1"     | 1110711 | 22 | 19 | 17 | 20 | 42  | 10 |
| 40 x 1 1/4" | 1110712 | 26 | 21 | 21 | 26 | 51  | 10 |
| 50 x 1 1/2" | 1110713 | 31 | 21 | 26 | 36 | 61  | 10 |
| 63 x 2"     | 1110714 | 38 | 26 | 33 | 45 | 75  | 10 |
| 75 x 2 1/2" | 1110715 | 44 | 30 | 39 | 53 | 89  | 10 |
| 90 x 3"     | 1110716 | 51 | 33 | 47 | 65 | 106 | 10 |
| 110 x 4"    | 1110717 | 61 | 39 | 57 | 79 | 129 | 10 |

**Kolano 90°**  
GOZ | KW x GZ

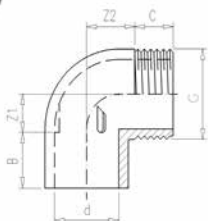

| D x G       | SYMBOL  | Z1 | Z2 | B  | C  | PN |
|-------------|---------|----|----|----|----|----|
| 20 x 3/4"   | 1120488 | 11 | 17 | 16 | 16 | 16 |
| 25 x 1"     | 1120489 | 17 | 20 | 19 | 19 | 16 |
| 32 x 3/4"   | 1120490 | 21 | 29 | 22 | 19 | 10 |
| 32 x 1"     | 1120491 | 21 | 30 | 22 | 19 | 10 |
| 32 x 1 1/4" | 1120492 | 17 | 24 | 22 | 21 | 10 |
| 40 x 1 1/4" | 1120493 | 22 | 27 | 26 | 21 | 10 |
| 40 x 1 1/2" | 1120494 | 22 | 27 | 26 | 21 | 10 |
| 50 x 1 1/4" | 1120495 | 28 | 34 | 31 | 21 | 10 |
| 50 x 1 1/2" | 1120496 | 28 | 34 | 31 | 21 | 10 |
| 50 x 2"     | 1120497 | 28 | 34 | 31 | 26 | 10 |

**Trójnik 90°**  
TIG | KW x GW x KW

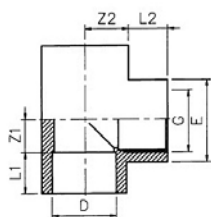

| D x G       | SYMBOL  | L1 | L2 | Z1 | Z2 | E   | PN |
|-------------|---------|----|----|----|----|-----|----|
| 16 x 3/8"   | 1110771 | 14 | 11 | 9  | 12 | 23  | 10 |
| 20 x 1/2"   | 1110772 | 16 | 15 | 11 | 12 | 28  | 10 |
| 25 x 3/4"   | 1110773 | 19 | 16 | 14 | 17 | 34  | 10 |
| 32 x 1"     | 1110774 | 22 | 19 | 17 | 20 | 42  | 10 |
| 40 x 1 1/4" | 1110775 | 26 | 21 | 21 | 26 | 51  | 10 |
| 50 x 1 1/2" | 1110776 | 31 | 21 | 26 | 36 | 61  | 10 |
| 63 x 2"     | 1110777 | 38 | 26 | 33 | 45 | 75  | 10 |
| 75 x 2 1/2" | 1110778 | 44 | 30 | 39 | 53 | 89  | 10 |
| 90 x 3"     | 1110779 | 51 | 33 | 47 | 65 | 106 | 10 |
| 110 x 4"    | 1110369 | 61 | 39 | 57 | 79 | 129 | 10 |

### Trójnik 90°

TIZ | KW x GZ x KW

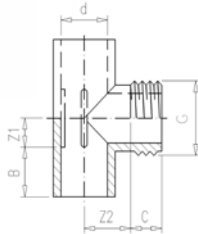

| D x G       | SYMBOL  | Z1 | Z2 | B  | C  | PN |
|-------------|---------|----|----|----|----|----|
| 20 x 3/4"   | 1120444 | 11 | 17 | 16 | 17 | 16 |
| 25 x 3/4"   | 1120445 | 14 | 20 | 19 | 17 | 16 |
| 25 x 1"     | 1120446 | 14 | 20 | 19 | 19 | 16 |
| 32 x 3/4"   | 1120447 | 17 | 23 | 22 | 17 | 16 |
| 32 x 1"     | 1120448 | 17 | 23 | 22 | 19 | 16 |
| 32 x 1 1/4" | 1120449 | 17 | 23 | 22 | 19 | 10 |
| 40 x 1"     | 1120450 | 23 | 27 | 26 | 19 | 16 |
| 40 x 1 1/4" | 1120451 | 23 | 27 | 26 | 21 | 10 |
| 40 x 1 1/2" | 1120452 | 23 | 27 | 26 | 21 | 16 |
| 50 x 1"     | 1120453 | 28 | 33 | 31 | 19 | 16 |
| 50 x 1 1/4" | 1120454 | 28 | 33 | 31 | 21 | 10 |
| 50 x 1 1/2" | 1120455 | 28 | 33 | 31 | 21 | 10 |
| 63 x 1"     | 1120456 | 34 | 42 | 38 | 19 | 16 |
| 63 x 1 1/4" | 1120457 | 34 | 42 | 38 | 21 | 16 |
| 63 x 1 1/4" | 1120458 | 34 | 42 | 38 | 21 | 16 |
| 63 x 2"     | 1120459 | 34 | 42 | 38 | 26 | 16 |
| 75 x 1 1/4" | 1120460 | 40 | 50 | 44 | 21 | 16 |
| 75 x 1 1/2" | 1120461 | 40 | 50 | 44 | 21 | 16 |
| 75 x 2"     | 1120462 | 40 | 50 | 44 | 26 | 16 |

### Mufa

MAG | KW x GW

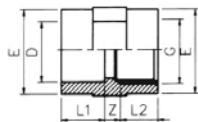

| D x G       | SYMBOL  | L1 | L2 | Z  | E   | PN |
|-------------|---------|----|----|----|-----|----|
| 12 x 1/4"   | 1120737 | 12 | 12 | 2  | 24  | 10 |
| 16 x 1/4"   | 1120529 | 14 | 12 | 3  | 27  | 10 |
| 16 x 3/8"   | 1110747 | 14 | 11 | 6  | 23  | 10 |
| 20 x 1/4"   | 1120531 | 16 | 12 | 5  | 32  | 10 |
| 20 x 3/8"   | 1120532 | 16 | 12 | 5  | 32  | 10 |
| 20 x 1/2"   | 1110748 | 17 | 15 | 4  | 28  | 10 |
| 25 x 3/8"   | 1120534 | 19 | 12 | 8  | 36  | 10 |
| 25 x 1/2"   | 1120533 | 19 | 15 | 5  | 46  | 10 |
| 25 x 3/4"   | 1110749 | 20 | 16 | 6  | 34  | 10 |
| 32 x 1/2"   | 1120535 | 22 | 15 | 10 | 46  | 10 |
| 32 x 3/4"   | 1120536 | 22 | 16 | 9  | 46  | 10 |
| 32 x 1"     | 1110750 | 23 | 19 | 7  | 42  | 10 |
| 40 x 3/4"   | 1120537 | 26 | 16 | 6  | 55  | 10 |
| 40 x 1"     | 1120538 | 26 | 22 | 4  | 55  | 10 |
| 40 x 1 1/4" | 1110751 | 28 | 21 | 7  | 51  | 10 |
| 50 x 1"     | 1120539 | 31 | 22 | 2  | 66  | 10 |
| 50 x 1 1/4" | 1120540 | 31 | 23 | 4  | 66  | 10 |
| 50 x 1 1/2" | 1110752 | 32 | 21 | 7  | 61  | 10 |
| 63 x 1 1/2" | 1120541 | 38 | 25 | 7  | 80  | 10 |
| 63 x 2"     | 1110753 | 39 | 26 | 7  | 75  | 10 |
| 75 x 1 1/2" | 1120739 | 44 | 23 | 5  | 94  | 10 |
| 75 x 2"     | 1120542 | 44 | 27 | 4  | 94  | 10 |
| 75 x 2 1/2" | 1110754 | 44 | 30 | 8  | 89  | 10 |
| 90 x 3"     | 1110755 | 51 | 33 | 9  | 106 | 10 |
| 110 x 4"    | 1110756 | 61 | 39 | 10 | 129 | 10 |

#### Powiązane produkty:

Klej UNI-100



Str. 144

Zmywacz



Str. 148

Nitka teflonowa



Str. 150

**Mufa z nakrętką**

MAV | KW x GW

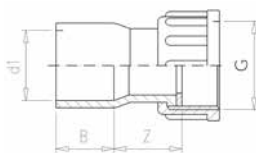

| D1 x G      | SYMBOL  | Z  | B  | PN |
|-------------|---------|----|----|----|
| 25 x 1"     | 1120770 | 30 | 27 | 16 |
| 32 x 1"     | 1120771 | 41 | 23 | 10 |
| 32 x 1 1/4" | 1120772 | 30 | 30 | 16 |
| 40 x 1 1/4" | 1120576 | 37 | 30 | 10 |
| 40 x 1 1/2" | 1120773 | 35 | 35 | 16 |
| 50 x 1 1/2" | 1120577 | 45 | 34 | 10 |
| 50 x 2"     | 1120774 | 43 | 37 | 16 |
| 63 x 2"     | 1120775 | 57 | 46 | 10 |
| 63 x 2 1/2" | 1120776 | 48 | 42 | 10 |
| 75 x 2 1/2" | 1120777 | 52 | 40 | 6  |
| 75 x 3"     | 1120778 | 50 | 55 | 6  |
| 90 x 3"     | 1120779 | 50 | 62 | 6  |

**Redukcja krótka**

RCG | KZ x GW

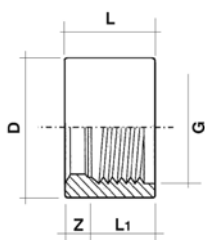

| D x G       | SYMBOL  | L  | Z    | L1   | PN |
|-------------|---------|----|------|------|----|
| 20 x 1/4"   | 1120528 | 22 |      | 14   | 16 |
| 25 x 1/2"   | 1110763 | 19 | 4    | 15   | 16 |
| 32 x 3/4"   | 1110764 | 22 | 5.7  | 16.3 | 16 |
| 40 x 1"     | 1110765 | 26 | 6.9  | 19.1 | 16 |
| 50 x 1 1/4" | 1110766 | 31 | 9.6  | 21.4 | 16 |
| 63 x 1 1/2" | 1110767 | 38 | 16.6 | 21.4 | 16 |
| 75 x 2"     | 1110768 | 44 | 18.3 | 25.7 | 16 |
| 90 x 2 1/2" | 1110769 | 51 | 20.8 | 30.2 | 16 |
| 110 x 3"    | 1110770 | 61 | 27.7 | 33.3 | 16 |

**Złączka**

ADG | KW x GZ

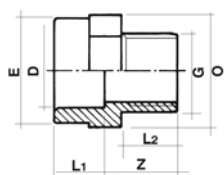

| D x G    | SYMBOL  | L1 | L2   | E   | Z  | O   | PN |
|----------|---------|----|------|-----|----|-----|----|
| 90 x 3"  | 1110600 | 51 | 33.3 | 106 | 46 | 115 | 16 |
| 110 x 4" | 1110601 | 61 | 39.3 | 129 | 47 | 130 | 16 |
| 160 x 6" | 1111049 | 86 | 48   | 188 | 60 | -   | 16 |



## Złączka

AFG | KZ x GW

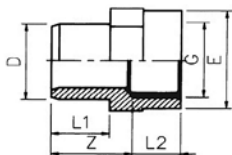

| D x G       | SYMBOL  | L1 | L2 | E   | Z  | PN |
|-------------|---------|----|----|-----|----|----|
| 16 x 3/8"   | 1110602 | 14 | 12 | 23  | 22 | 10 |
| 20 x 1/2"   | 1110603 | 16 | 15 | 28  | 24 | 10 |
| 20 x 3/4"   | 1110604 | 16 | 16 | 34  | 24 | 10 |
| 25 x 1/2"   | 1110605 | 19 | 15 | 28  | 27 | 10 |
| 25 x 3/4"   | 1110606 | 19 | 16 | 34  | 27 | 10 |
| 25 x 1"     | 1110607 | 19 | 19 | 42  | 27 | 10 |
| 32 x 3/4"   | 1110608 | 22 | 16 | 34  | 30 | 10 |
| 32 x 1"     | 1110609 | 22 | 19 | 42  | 30 | 10 |
| 40 x 1"     | 1110610 | 26 | 19 | 42  | 36 | 10 |
| 40 x 1 1/4" | 1110611 | 26 | 21 | 51  | 36 | 10 |
| 50 x 1 1/4" | 1110612 | 31 | 21 | 55  | 41 | 10 |
| 50 x 1 1/2" | 1110613 | 31 | 21 | 58  | 41 | 10 |
| 50 x 2"     | 1110614 | 31 | 26 | 72  | 41 | 10 |
| 63 x 2"     | 1110615 | 38 | 26 | 72  | 48 | 10 |
| 75 x 2"     | 1110616 | 44 | 26 | 72  | 53 | 10 |
| 75 x 2 1/2" | 1110617 | 44 | 30 | 89  | 58 | 10 |
| 75 x 3"     | 1110618 | 44 | 33 | 103 | 58 | 10 |
| 90 x 2 1/2" | 1110619 | 51 | 30 | 89  | 65 | 10 |
| 90 x 3"     | 1110620 | 51 | 33 | 103 | 65 | 10 |
| 90 x 4"     | 1110621 | 51 | 39 | 130 | 65 | 10 |
| 110 x 3"    | 1110623 | 61 | 33 | 103 | 76 | 10 |
| 110 x 4"    | 1110622 | 61 | 39 | 130 | 76 | 10 |

## Redukcja przejściowa

AMG | KW x KZ x GZ

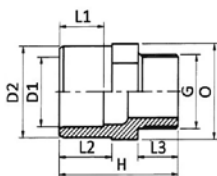

| D1 - D2 x G       | SYMBOL  | L1 | L2 | L3 | O   | PN |
|-------------------|---------|----|----|----|-----|----|
| 12 x 16 x 3/8"    | 1110636 | 12 | 14 | 11 | 22  | 16 |
| 16 x 20 x 3/8"    | 1110638 | 14 | 16 | 11 | 24  | 16 |
| 16 x 20 x 1/2"    | 1110639 | 14 | 16 | 15 | 24  | 16 |
| 20 x 25 x 3/8"    | 1110640 | 16 | 19 | 11 | 30  | 16 |
| 20 x 25 x 1/2"    | 1110641 | 16 | 19 | 15 | 30  | 16 |
| 20 x 25 x 3/4"    | 1110642 | 16 | 19 | 16 | 30  | 16 |
| 25 x 32 x 1/2"    | 1110643 | 19 | 22 | 15 | 36  | 16 |
| 25 x 32 x 3/4"    | 1110644 | 19 | 22 | 16 | 36  | 16 |
| 25 x 32 x 1"      | 1110645 | 19 | 22 | 19 | 36  | 16 |
| 32 x 40 x 1/2"    | 1110646 | 22 | 26 | 16 | 46  | 16 |
| 32 x 40 x 3/4"    | 1110647 | 22 | 26 | 15 | 46  | 16 |
| 32 x 40 x 1"      | 1110648 | 22 | 26 | 19 | 46  | 16 |
| 32 x 40 x 1 1/4"  | 1110649 | 22 | 26 | 21 | 46  | 16 |
| 40 x 50 x 1"      | 1110650 | 26 | 31 | 19 | 55  | 16 |
| 40 x 50 x 1 1/4"  | 1110651 | 26 | 31 | 21 | 55  | 16 |
| 40 x 50 x 1 1/2"  | 1110652 | 26 | 31 | 21 | 55  | 16 |
| 50 x 63 x 1 1/4"  | 1110653 | 31 | 38 | 21 | 65  | 16 |
| 50 x 63 x 1 1/2"  | 1110654 | 31 | 38 | 21 | 65  | 16 |
| 50 x 63 x 2"      | 1110655 | 31 | 38 | 26 | 65  | 16 |
| 63 x 75 x 1 1/2"  | 1110656 | 38 | 44 | 21 | 80  | 16 |
| 63 x 75 x 2"      | 1110657 | 38 | 44 | 26 | 80  | 16 |
| 63 x 75 x 2 1/2"  | 1110658 | 38 | 44 | 30 | 80  | 16 |
| 75 x 90 x 2"      | 1110659 | 44 | 52 | 26 | 95  | 16 |
| 75 x 90 x 2 1/2"  | 1110660 | 44 | 52 | 30 | 95  | 16 |
| 75 x 90 x 3"      | 1110661 | 44 | 52 | 33 | 95  | 16 |
| 90 x 110 x 2 1/2" | 1110662 | 51 | 61 | 30 | 115 | 16 |
| 90 x 110 x 3"     | 1110663 | 51 | 61 | 33 | 115 | 16 |
| 90 x 110 x 4"     | 1110664 | 51 | 61 | 39 | 115 | 16 |
| 110 x 125 x 3"    | 1110665 | 61 | 66 | 33 | 130 | 16 |
| 110 x 125 x 4"    | 1110666 | 61 | 66 | 39 | 130 | 16 |
| 110 x 125 x 5"    | 1110667 | 61 | 66 | 39 | 130 | 16 |

## Powiązane produkty:

Taśma



Str. 150

### Trójnik 90° wzmacniony

TIR | KW x GW x KW

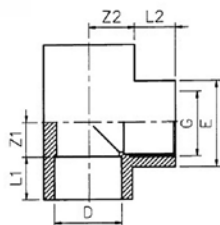

| D x G       | SYMBOL  | L1 | L2 | Z1   | Z2   | PN |
|-------------|---------|----|----|------|------|----|
| 16 x 3/8"   | 1120463 | 14 | 12 | 9    | 11   | 16 |
| 20 x 1/2"   | 1110780 | 16 | 15 | 11   | 17   | 16 |
| 25 x 1/2"   | 1120466 | 19 | 16 | 14   | 14   | 16 |
| 25 x 3/4"   | 1110781 | 19 | 16 | 14   | 17   | 16 |
| 32 x 1/2"   | 1120468 | 22 | 16 | 17   | 17   | 16 |
| 32 x 1"     | 1110782 | 22 | 19 | 17   | 20   | 16 |
| 40 x 1 1/4" | 1110783 | 27 | 21 | 21   | 26   | 16 |
| 50 x 1 1/2" | 1110784 | 32 | 21 | 26   | 36   | 16 |
| 63 x 2"     | 1110785 | 39 | 26 | 33   | 45   | 16 |
| 75 x 2 1/2" | 1120717 | 44 | 34 | 38.5 | 48.5 | 10 |
| 90 x 3"     | 1120718 | 51 | 41 | 46   | 56   | 10 |
| 110 x 4"    | 1120719 | 61 | 41 | 56   | 77   | 10 |

### Złączka wzmacniona

AFR | KZ x GW

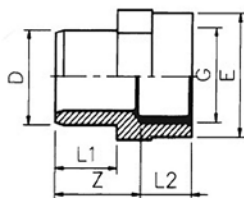

| D x G       | SYMBOL  | L1 | L2 | E  | Z  | PN |
|-------------|---------|----|----|----|----|----|
| 16 x 3/8"   | 1120543 | 12 | 12 | 27 | 14 | 16 |
| 20 x 1/2"   | 1110624 | 16 | 15 | 28 | 24 | 16 |
| 20 x 3/4"   | 1110625 | -  | -  | -  | -  | 16 |
| 25 x 1/2"   | 1110626 | 14 | 15 | 32 | 19 | 16 |
| 25 x 3/4"   | 1110627 | 19 | 16 | 34 | 27 | 16 |
| 25 x 1"     | 1110628 | -  | -  | -  | -  | 16 |
| 32 x 3/4"   | 1110629 | 16 | 16 | 36 | 22 | 16 |
| 32 x 1"     | 1110630 | 22 | 19 | 42 | 30 | 16 |
| 40 x 1"     | 1110632 | -  | -  | -  | -  | 16 |
| 40 x 1 1/4" | 1110631 | 27 | 21 | 51 | 36 | 16 |
| 50 x 1 1/4" | 1110633 | -  | -  | -  | -  | 16 |
| 50 x 1 1/2" | 1110634 | 26 | 25 | 66 | 31 | 16 |
| 63 x 2"     | 1120544 | 32 | 28 | 80 | 38 | 10 |
| 75 x 2 1/2" | 1120545 | 38 | 31 | 94 | 44 | 16 |

### Mufa wzmacniona

MAR | KW x GW

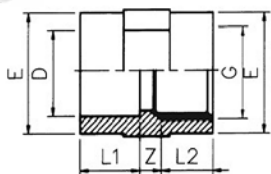

| D x G       | SYMBOL  | L1 | L2 | Z  | E  | PN |
|-------------|---------|----|----|----|----|----|
| 16 x 3/8"   | 1120530 | 14 | 12 | 3  | 27 | 16 |
| 20 x 1/2"   | 1110757 | 16 | 15 | 4  | 28 | 16 |
| 25 x 3/4"   | 1110758 | 19 | 16 | 6  | 34 | 16 |
| 32 x 1"     | 1110759 | 22 | 19 | 6  | 42 | 16 |
| 40 x 1 1/4" | 1110760 | 27 | 21 | 8  | 51 | 16 |
| 50 x 1 1/2" | 1110761 | 32 | 21 | 13 | 61 | 16 |
| 63 x 2"     | 1110762 | 39 | 26 | 15 | 75 | 16 |

### Kolano 90° wzmacnione

GOR | KW x GW

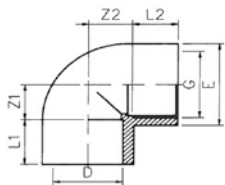

| D x G       | SYMBOL  | L1 | L2 | Z1 | Z2 | E  | PN |
|-------------|---------|----|----|----|----|----|----|
| 16 x 3/8"   | 1120500 | 14 | 12 | 11 | 11 | -  | 16 |
| 20 x 1/2"   | 1110718 | 16 | 15 | 11 | 12 | 28 | 16 |
| 25 x 3/4"   | 1110719 | 19 | 16 | 14 | 17 | 34 | 16 |
| 32 x 1"     | 1110720 | 22 | 19 | 17 | 20 | 42 | 16 |
| 40 x 1 1/4" | 1110721 | 26 | 21 | 21 | 26 | 51 | 16 |
| 50 x 1 1/2" | 1110722 | 31 | 21 | 26 | 36 | 61 | 16 |
| 63 x 2"     | 1110723 | 38 | 26 | 33 | 45 | 75 | 16 |
| 75 x 2 1/2" | 1120726 | 44 | 36 | 39 | 47 | -  | 10 |
| 90 x 3"     | 1120501 | 51 | 39 | 46 | 58 | -  | 10 |
| 110 x 4"    | 1120727 | 61 | 39 | 56 | 78 | -  | 10 |

### Adaptor

AMV | KW x KZ x Victaulic®

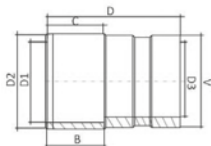

| D1 x D2 x V                        | SYMBOL  | D3   | B  | C  | D  | PN |
|------------------------------------|---------|------|----|----|----|----|
| 40 x 50 x 1 1/2" Victaulic® = 48.3 | 1120654 | 38.5 | 26 | 31 | 71 | 10 |
| 50 x 63 x 2" Victaulic® = 60.3     | 1120655 | 44   | 31 | 38 | 78 | 10 |
| 63 x 75 x 2 1/2" Victaulic® = 73.0 | 1121347 | 58   | 38 | 44 | 84 | 10 |

### Złączka węży

PGD | KZ x węży

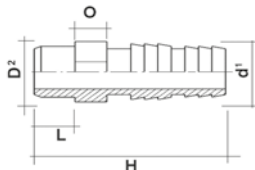

| D2 x D1 | SYMBOL  | L  | H   | O  | PN |
|---------|---------|----|-----|----|----|
| 10 x 10 | 1120549 | 12 | 43  | -  | 10 |
| 12 x 12 | 1120550 | 12 | 48  | -  | 10 |
| 16 x 16 | 1110246 | 14 | 66  | 19 | 10 |
| 20 x 20 | 1110247 | 16 | 70  | 24 | 10 |
| 25 x 25 | 1110248 | 19 | 79  | 30 | 10 |
| 32 x 32 | 1110249 | 22 | 83  | 36 | 10 |
| 40 x 40 | 1110250 | 26 | 96  | 46 | 10 |
| 50 x 50 | 1110251 | 31 | 108 | 55 | 10 |
| 63 x 60 | 1110252 | 38 | 130 | 65 | 10 |

### Złączka węży

PGW | GW x węży

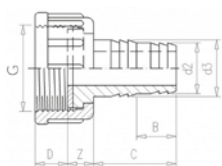

| G x D2      | SYMBOL  | D3 | Z  | B  | C  | D  | PN |
|-------------|---------|----|----|----|----|----|----|
| 3/4" x 16   | 1120552 | 18 | 17 | 18 | 40 | 11 | 10 |
| 1" x 20     | 1120553 | 22 | 17 | 20 | 44 | 11 | 10 |
| 1 1/4" x 25 | 1120554 | 28 | 17 | 24 | 54 | 13 | 10 |
| 1 1/2" x 32 | 1120555 | 34 | 20 | 28 | 63 | 13 | 10 |
| 2" x 40     | 1120556 | 43 | 20 | 32 | 72 | 15 | 10 |
| 2 1/4" x 50 | 1120557 | 53 | 23 | 35 | 80 | 16 | 10 |
| 2 3/4" x 60 | 1120558 | 66 | 23 | 40 | 90 | 21 | 10 |

### Złączka węży

PGE | GZ x węży

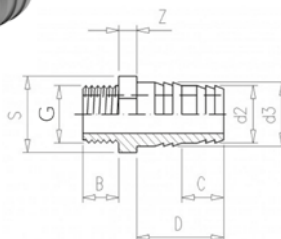

| G x D2      | SYMBOL  | D3 | Z  | B  | C  | D  | S  | PN |
|-------------|---------|----|----|----|----|----|----|----|
| 1/4" x 12   | 1120551 | 14 | 6  | 11 | 16 | 36 | 15 | 10 |
| 3/8" x 16   | 1110542 | 18 | 7  | 12 | 18 | 40 | 19 | 10 |
| 1/2" x 20   | 1110543 | 22 | 8  | 15 | 20 | 44 | 24 | 10 |
| 3/4" x 25   | 1110544 | 28 | 8  | 16 | 24 | 54 | 30 | 10 |
| 1" x 32     | 1110545 | 34 | 9  | 18 | 28 | 63 | 35 | 10 |
| 1 1/4" x 40 | 1110546 | 43 | 13 | 21 | 32 | 72 | 46 | 10 |
| 1 1/2" x 50 | 1110547 | 56 | 14 | 21 | 35 | 80 | 55 | 10 |
| 2" x 60     | 1110548 | 66 | 16 | 26 | 40 | 90 | 70 | 10 |